

GIGA X8c/X8

Cleaning the machine

Approximate duration 20 min.

Equipment required:
2-phase-cleaning tablets
Box containing 25 pcs (Art. 62535)



Pack containing 6 pcs (Art. 62715)



These short instructions do not replace the 'GIGA X8c/X8 Instructions for Use'. Make sure you read and observe the safety information and warnings first in order to avoid hazards.

'Display'

Precondition: 'Clean machine'

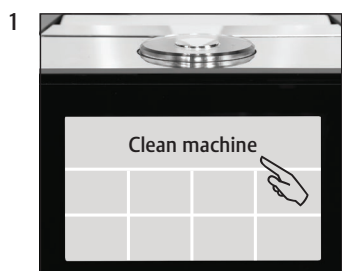

'Clean'



'Empty coffee grounds container'

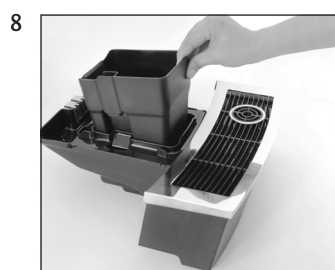
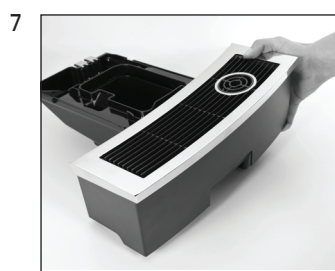
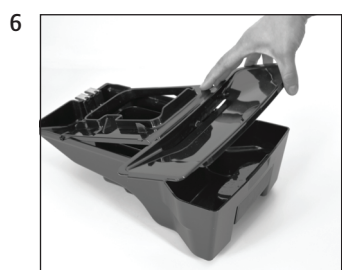
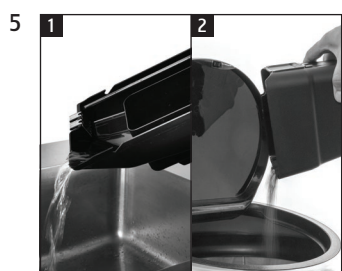

'Press the Rotary Switch'



'Machine is being cleaned'
'Add cleaning tablet'

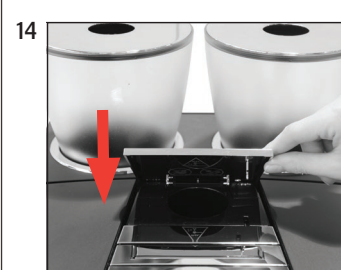
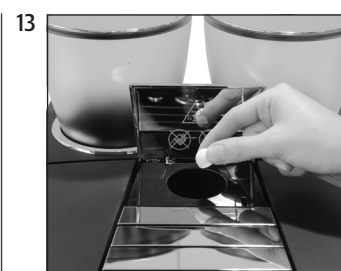
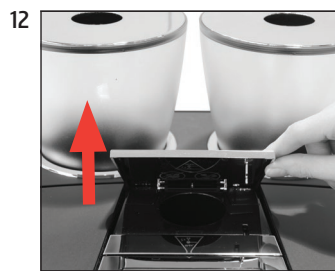

'Press the Rotary Switch'



'Machine is being cleaned'
'Empty coffee grounds container'

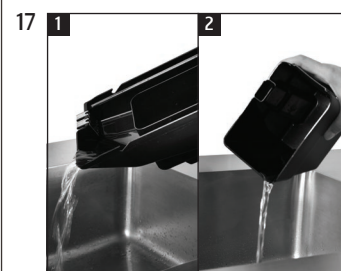

'Clean' / 'Cleaning complete.'